

MODEL: C2599-I

External M.2 NVMe SSD Enclosure

USB 3.1 Gen 2 Type-C To M.2 NVMe SSD

www.ineo-usa.com

Getting Started

Thank you for purchasing ineo C2599-I External M.2 NVMe SSD Enclosure. This quick install guide provides step-by-step installation instructions and other important information regarding your ineo product. For the latest ineo product information and news, please visit our website at <http://www.ineo-usa.com>

Package Contents

C2599-I	M.2 NVMe to USB 3.1 Gen 2
Type C to USB A cable	Yes(Integrated on enclosure)
Silicon Thermal Pad	Yes
Screw Kit	Screw Driver x 1, Screws x 4
Guarantee Card	Yes
User Manual	Yes

System Requirements

Hardware

Pentium® II, 200 MHz equivalent or newer for IBM compatible PC
PowerPC G4, 350 MHz or newer for PowerPC-based Apple Computer
Core® or newer for Intel-based Apple Computer

Software

Windows 2000/Mac9.1/Linux for USB2.0
Windows XP / VISTA / 7 / 8 / 8.1 / 10 & Mac OS X v.10.2+ for USB3.0
Windows 8.1 / 10 & macOS 10.12+ For USB 3.1 Gen 2

Note: For highest performance and reliability, ineo recommends that you install the latest service pack (SP) and updates.

■ Updating Your Operating System

Windows

Go to the Start menu and select Windows updates. For more information regarding updating your system, visit <http://windowsupdate.microsoft.com>.

Macintosh

Go to the Apple menu and select Software Update. For more information regarding updating your system, visit <http://www.apple.com/macosx>.

■ Handling Precautions

Ineo products are precision instruments and must be handled with care during unpacking and installation. Drives may be damaged by rough handling, shock, or vibration. Be aware of the following precautions when unpacking your ineo external storage kit:

- ▶ Do not unpack the product until you are ready to install it.
- ▶ Do not drop or jolt the product.
- ▶ Do not move the external storage when it is powered up.

Hard Disk Drive Installation

- 1** Unscrew the 4 screws from the case.

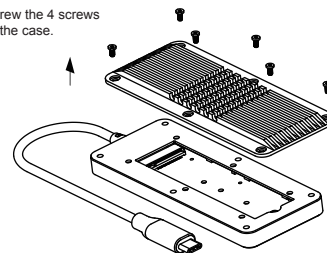

- 2** Insert the M.2 SSD card and lock the screw to secure it.

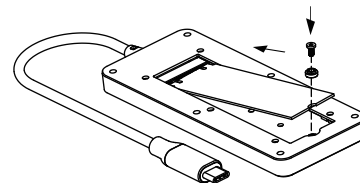

- 3** Apply thermal silicon to the M.2 SSD card.

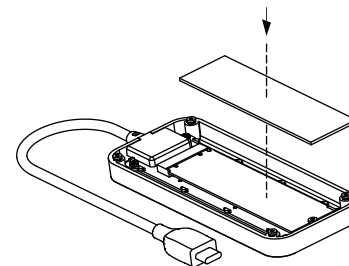

- 4** Cover the top cover and lock the screws. The installation is complete.

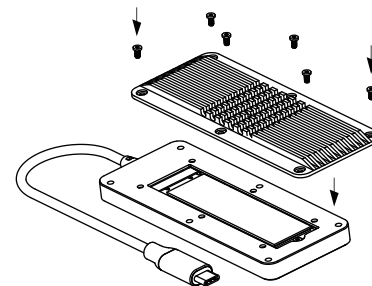

EMC259901IN-US